















Musterplan
Eigentum Feuerwehr Herford

- Legende**
-  Zugang
 -  Fw.-Blitzleuchte
 -  Fw.- Schlüsseldepot
 -  Brandmeldezentrale
 -  Treppe mit baulicher Trennung
 -  Treppe ohne bauliche Trennung
 -  Brandwand
 -  Überflurhydrant
 -  Unterflurhydrant
 -  LW-Behälter 30m³ unterirdisch
 -  Saugstelle für Löschmittel
 -  Löschwasser-Einspeisung (B-Anschluss)
 -  Elektrizität
 -  Feuergefährliche Stoffe



Musterbau Metallverarbeitung
Bauweg 12a
32051 Herford

Übersichtsplan
Stand: Juni 2019 **Plan 01**

**Musterplan
Eigentum Feuerwehr Herford**

1000

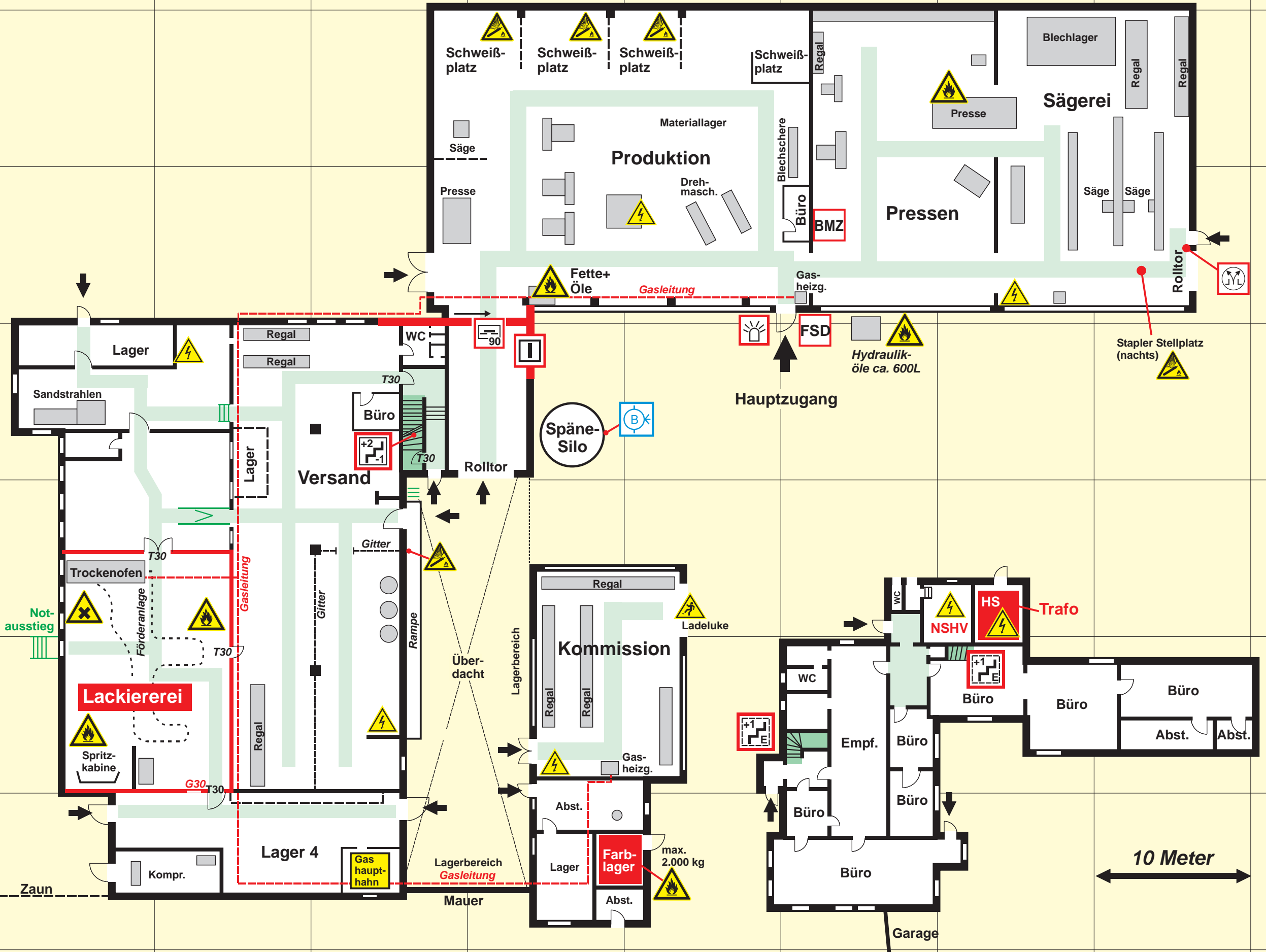
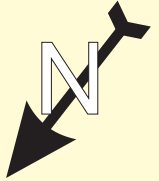





- Legende**
- Zugang
 - Fw.-Blitzleuchte
 - FSD Fw.- Schlüsseldepot
 - BMZ Brandmeldezentrale
 - Bedienstelle Rauchabzug
 - Treppe mit baulicher Trennung
 - Treppe ohne bauliche Trennung
 - Brandwand
 - Wand F90
 - Feuerschutzschiebetor
 - Reizende Stoffe
 - Elektrizität
 - Gasflaschen
 - Feuergefährliche Stoffe
 - Absturzgefahr
 - Löschwasser-Einspeisung (B-Anschluss)
 - Hauptbewegungsfläche

Musterbau Metallverarbeitung
Bauweg 12a
32051 Herford

Erdgeschoss
Stand: Juni 2019 **Plan 02**



Legende

-  Treppe mit baulicher Trennung
-  Treppe ohne bauliche Trennung
-  Absturzgefahr
-  Hauptbewegungsfläche

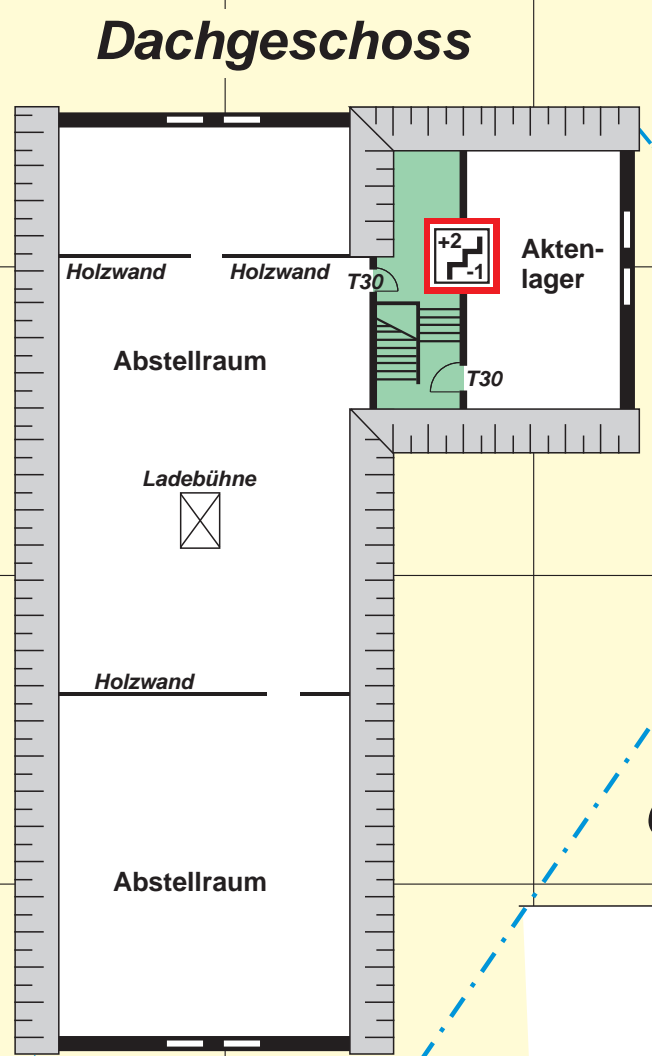

Obergeschoss

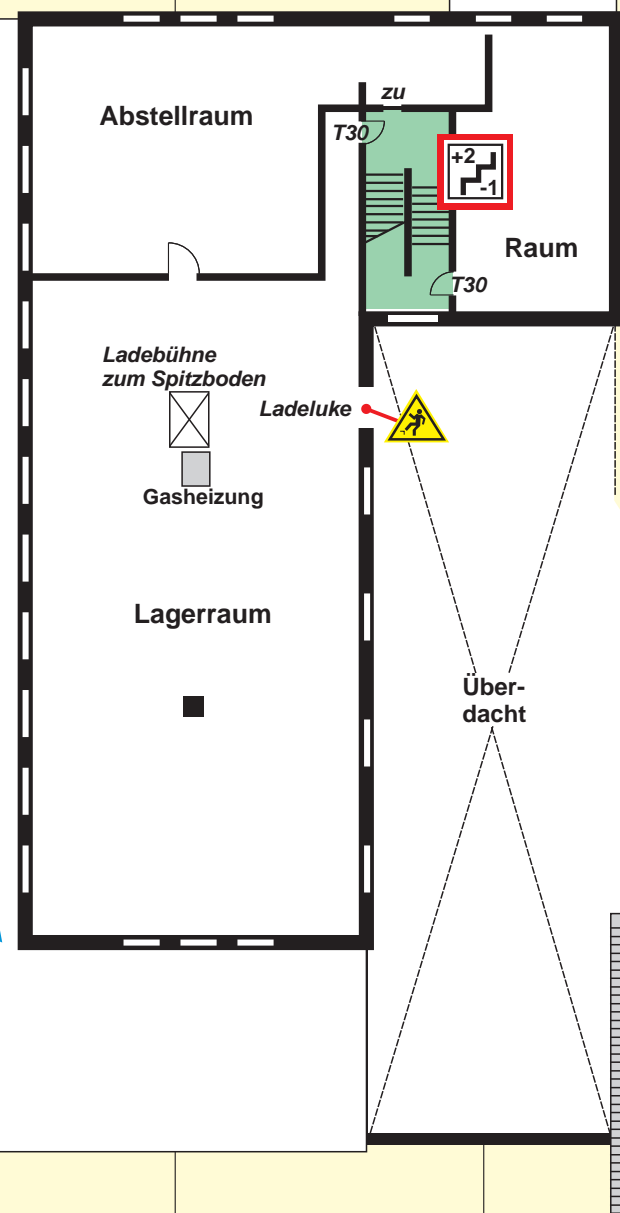

Dach EG

10 Meter

Obergeschoss

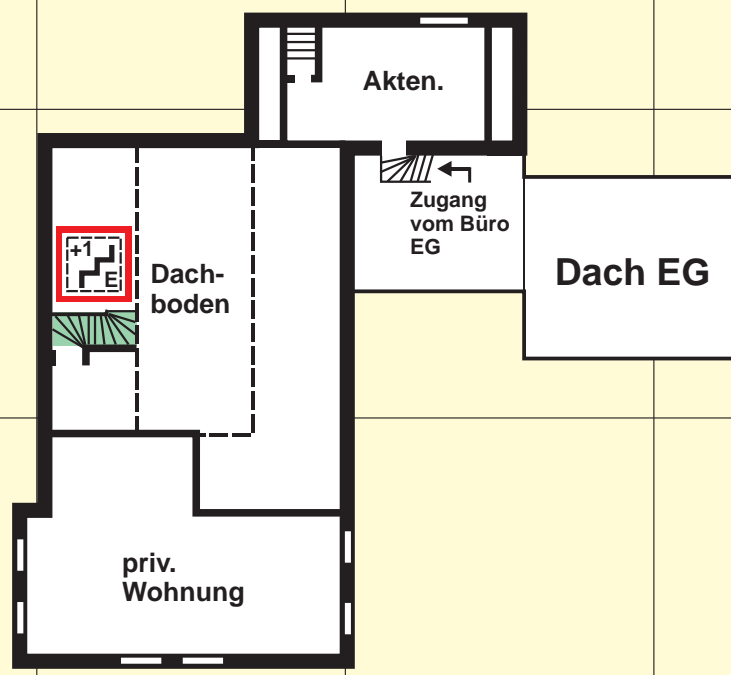

Musterbau Metallverarbeitung
 Bauweg 12a
 32051 Herford

1.Obergeschoss /
 Dachgeschoss

Stand: Juni 2019 **Plan 03**